

WEBER 40 DCOE emission model - exploded view

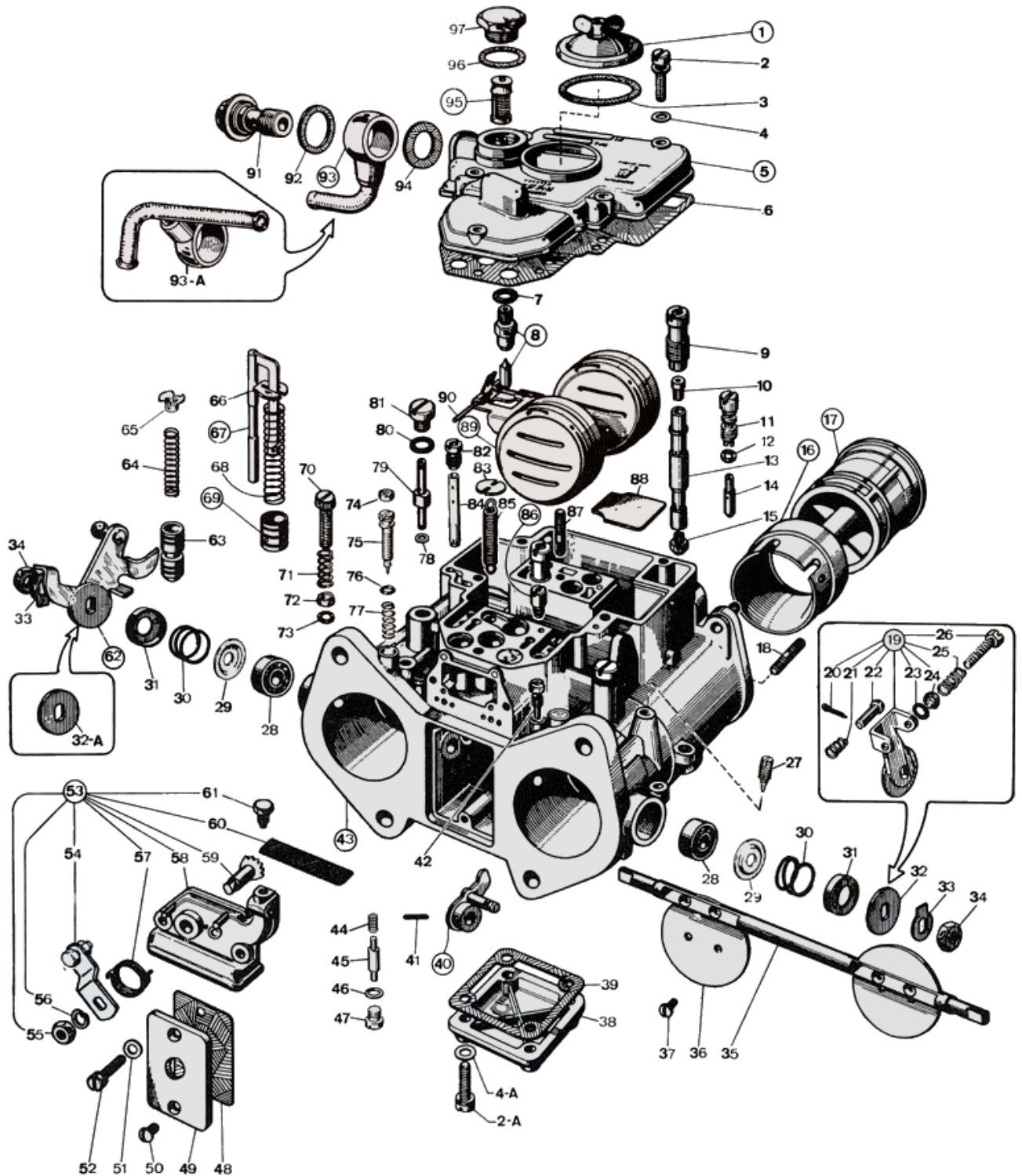

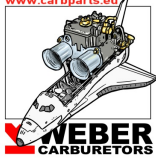

Selling carburetor parts since 2005



WEBER 40 DCOE emission model - Parts list

No	Part No	Price	Pcs	Description	No	Part No	Price	Pcs	Description
1	32376.003	\$ 0	1	Jet inspection cover	49	52135.024	\$ 0	1	Inspection plate
2	64700.001	\$ 0	5	Top Cover Screw	50	64570.009	\$ 0	2	Inspection Cover Fixing Screw
2A	64700.001	\$ 0	4	Fixing Screw	51	55510.038	\$ 0	2	Flat Washer
3	41550.002	\$ 0	1	Jet Inspection Cover Gasket	52	64700.004	\$ 0	2	Choke cover fixing screw
4	55510.034	\$ 0	5	Spring Washer	53	32556.002	\$36.3	1	Cold Start Unit
4A	55510.034	\$ 0	4	Spring Washer	53	32556.018	\$ 0	1	Cold start unit (40 DCOE 106)
5	31734.098	\$ 0	1	Top cover (40 DCOE 106)	54	45027.030	\$ 0	1	— Cold Start Lever Assembly
5	31734.099	\$ 0	1	Top cover (40 DCOE 107)	55	34715.010	\$ 0	1	— Lever fixing nut
6	41715.001	\$ 0	1	Carburettor Cover Gasket	56	55525.010	\$ 0	1	— Spring washer
7	83102.100	\$ 0	1	Needle valve gasket	57	47610.006	\$ 0	1	— Lever return spring
8	79503.150*	\$ 11.3	1	Float valve	58	32556.001	\$ 0	1	— Cold Start Unit
9	52580.001	\$ 0	2	Emulsion Tube Holder	59	10085.003	\$ 0	1	— Starting shaft
10	77401.180*	\$ 4.5	2	Air bleed jet	60	37000.016	\$ 0	1	— Filter Screen
11	52585.005	\$ 108	2	Idle Jet Holder	61	64605.017	\$ 0	1	Choke Cable Clamp
12	41565.015	\$ 0	2	Idle Mixture Screw O Ring	62	45041.085	\$ 0	1	Throttle lever (40 DCOE 107)
13	61450.057*	\$ 0	2	Emulsion Tube	63	64330.003	\$ 0	2	Starter valve
14	74833.055*	\$ 0	2	Idle Jet	64	47600.005	\$ 2.2	2	Starter Valve Spring
15	73401.132*	\$ 3.8	2	Main Jet	65	52030.003	\$ 0	2	Guide Bush for spring
16	72302.300*	\$ 13.1	2	Choke tube	66	52140.010	\$ 0	1	Pump Screen retainer
17	70001.600*	\$ 0	2	Auxiliary venturi	67	10410.025	\$ 0	1	Pump Rod
18	64955.108	\$ 0	2	Air horns stud	68	47600.034	\$ 0	1	Spring
19	45048.018	\$ 0	1	Synchro lever (40 DCOE 106) consist of:	69	58602.013	\$ 0	1	Pump plunger
20	32610.002	\$ 0	1	- Spilt pin	70	64585.005	\$ 0	1	Throttle stop screw
21	47600.093	\$ 0	1	- Spring	71	47600.007	\$ 0	1	Throttle Stop Screw Spring
22	52010.097	\$ 0	1	- Pin	72	58000.006	\$ 0	1	Throttle Stop Screw O Ring Cap
23	41565.002	\$ 0	1	- O-Ring	73	41565.002	\$ 0	1	Throttle Stop Screw 'O' Ring
24	58000.006	\$ 0	1	- Throttle Stop Screw O Ring Cap	74	61075.021	\$ 0	2	Idle mixture screw tamper proof plug
25	47600.094	\$ 0	1	- Spring	75	64750.058	\$ 0	2	Idle Mixture Screw
26	64625.015	\$ 0	1	- Screw	76	41565.015	\$ 0	2	Idle Mixture Screw O Ring
27	64595.012	\$ 0	2	Air by-pass screw	77	47600.007	\$ 0	2	Idle Mixture Screw Spring
28	32650.001	\$ 0	2	Throttle Shaft Bearing	78	41535.021	\$ 0	2	Pump Jet Gasket
29	58000.002	\$ 0	2	Spring Retaining Cover	79	76801.030*	\$ 6.7	2	Pump jet
30	47600.063	\$ 0	2	Spring	80	41565.009	\$ 0	2	Pump Jet Cover O ring
31	58000.007	\$ 0	2	Retaining Cover	81	61015.008	\$ 0	2	Pump jet cover
32A	55555.010	\$ 0	1	Washer For Shaft	82	77505.150*	\$ 0	2	Emulsion tube holder air corrector
32	55555.010	\$ 0	1	Washer For Shaft	83	52210.006	\$ 0	1	Spring Anchor Plate
33	55520.004	\$ 0	2	Throttle Shaft Lock Washer	84	75507.085*	\$ 8.3	2	Starter Jet
34	34710.003	\$ 0	2	Throttle Spindle Nut	85	47605.009	\$ 0	1	Throttle Return Spring
35	10005.401	\$ 0	1	Throttle Shaft	86	79701.000*	\$ 9.4	1	Back bleed valve
36	64005.059	\$ 0	2	Throttle Valve	87	64955.007	\$ 0	1	Inspection cover stud
37	64570.006	\$ 0	4	Throttle Plate Screw	88	52130.003	\$ 0	1	Plate
38	32374.008	\$ 0	1	Bottom Cover	89	41030.005	\$ 0	1	Float
39	41640.001	\$ 0	1	Bottom cover gasket	90	52000.001	\$ 0	1	Float Fulcrum Pin
40	45082.005	\$ 0	1	Pump Cam	91	12715.008	\$ 0	1	Fuel Union Bolt
41	58445.001	\$ 0	1	Fixing Pin	92	41530.024	\$ 0	1	Fuel Filter Gasket
42	64590.008	\$ 0	2	Vacuum screw cap	93	10536.035	\$ 0	1	Fuel union (40 DCOE 107)
43	-	\$ 8.3	1	Carburetor Body	93	10536.034	\$ 0	1	Fuel union (40 DCOE 106)
44	47600.224	\$ 0	1	Bush retaining spring	94	41530.031	\$ 0	1	Fuel Union Gasket
45	64330.013	\$ 0	1	Valve	95	37022.002	\$ 0	1	Filter element
46	41530.012	\$ 0	1	Pump jet gasket	96	41530.024	\$ 0	1	Fuel Filter Gasket
47	61015.014	\$ 0	1	Pump Demand Valve Cover	97	61002.010	\$ 0	1	Fuel Filter Cover
48	41640.021	\$ 0	1	Pump cover gasket					

<https://www.carbparts.eu>

Prices and product availability are subject to change

