

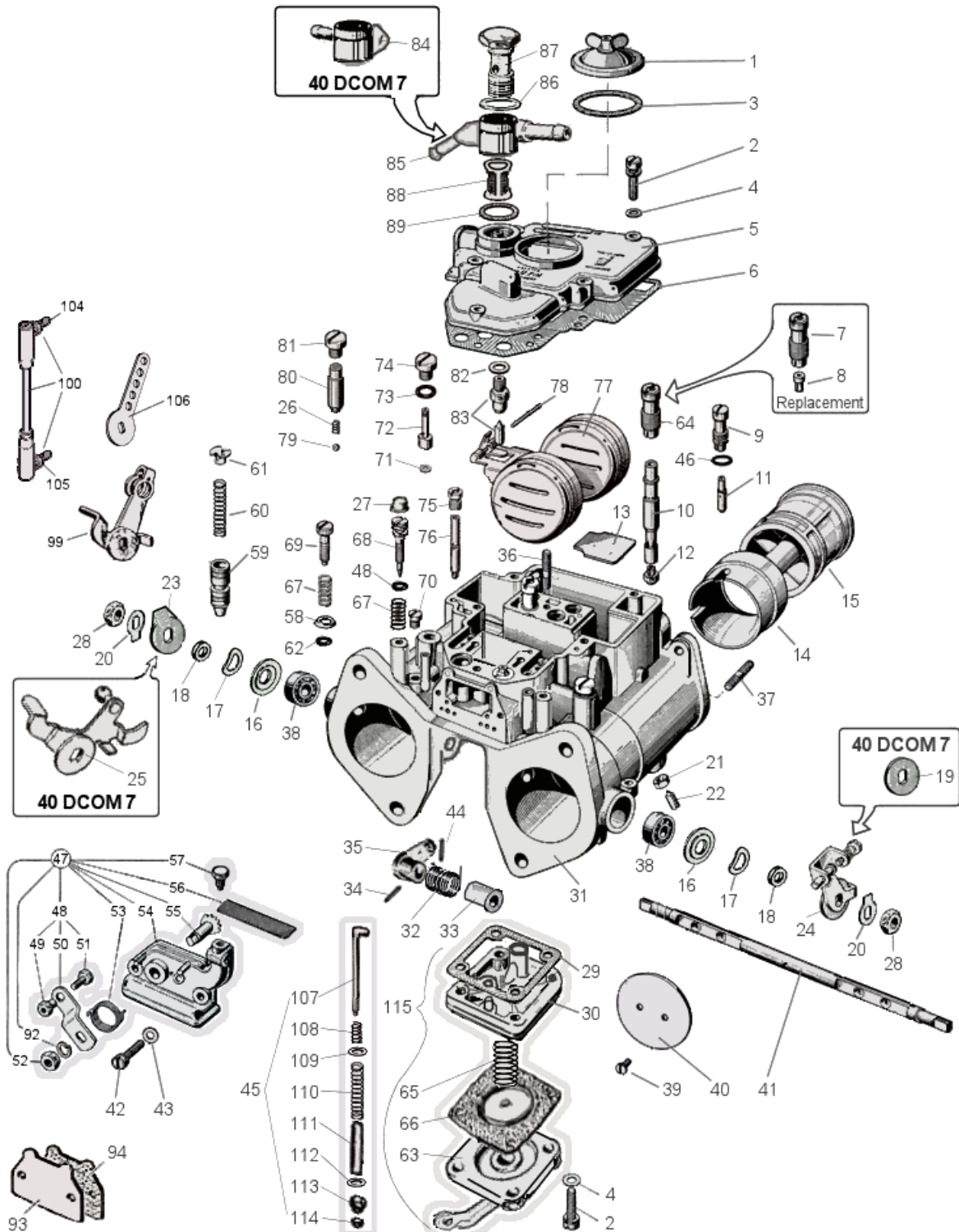

WEBER 40 DCOM 6/7 - exploded view



<https://www.carbparts.eu>

Prices and product availability are subject to change



CarbDeal
Selling carburetor parts since 2005



WEBER 40 DCOM 6/7 - Parts list

No	Part No	Price	Pcs	Description	No	Part No	Price	Pcs	Description
1	32376.003	£ 6.8	1	Jet Cover	54	32556.001	£ 0	1	Cold Start Unit Body
2	64700.001	£ 0.5	9	Cover Screw	55	10085.003	£ 0	1	Shaft
3	41550.002	£ 2.2	1	Gasket	56	37000.016	£ 3.2	1	Filter Screen
4	55510.034	£ 0.4	5	Washer	57	64605.017	£ 1.5	1	Fixing Bolt
5		£ 0	1	Carb Top Cover	58	58000.006	£ 1.7	1	Cup washer
6	41715.011	£ 1.4	1	Carb. Cover Gasket	59	64330.014	£ 5	2	Starter Valve
7	52580.001	£ 3.9	2	Emulsion Tube Holder	60	47600.243	£ 3.8	2	Starter Valve Spring
8	77401	£ 3.7	2	Air Corrector Jet	61	52030.003	£ 2.5	2	Spring Retainer
9	52585.005	£ 15.3	2	Idle Jet Holder	62	41565.002	£ 0.4	2	O ring
10	61450.261	£ 0	2	Emulsion Tube	63		£ 0	1	Pump bottom
11	74800	£ 2.5	2	Idle Jet	64	77511.160	£ 0	2	Emulsion tube holder with air corrector
12	73401	£ 10.8	2	Main Jet	65	47600.250	£ 4.3	1	Pump Spring
13	52130.003	£ 1.4	1	Plate	66	47407.267	£ 10	1	Pump Diaphragm
14	72303.320	£ 0	2	Choke Tube	67	47600.007	£ 1.9	2	Idle Screw Spring
15	69909.600	£ 49.7	2	Auxiliary Venturi	68	64750.058	£ 4.3	2	Idle Mixture Screw
16	41570.001	£ 0.9	2	Dust Cover	69	64625.012	£ 4.7	1	Throttle stop screw
17	47600.063	£ 1.7	2	Spring	70	61015.002	£ 4.3	2	Progression Hole Plug
18	58000.007	£ 2.3	2	Retaining Cover	71	41535.021	£ 1	2	Pump Gasket
19	55555.010	£ 1.4	1	Washer	72	76818.035	£ 4.2	2	Pump Jet
20	55520.004	£ 0.9	2	Lock washer	73	41565.009	£ 0.5	2	Pump Cover Seal
21	34710.003	£ 0.9	1	Lock Nut	74	61015.008	£ 6.5	2	Pump Cover
22	64830.006	£ 3.2	1	Locking screw	75	77505.150	£ 5	1	Starter air jet
23		£ 0	1	Stop washer	76	75507.085	£ 8.6	2	Starter Jet
24	45048.149	£ 12.9	1	Balance lever	77	41030.005	£ 28.3	1	Float
25		£ 0	1	Throttle lever	78	52000.001	£ 1.4	1	Float Fulcrum Pin
26	47600.296	£ 0	1	Spring	79	58300.003	£ 1.8	2	Pump Valve Ball
27	61075.021	£ 0	1	Mixture screw cap	80	52730.004	£ 8	2	Stuffing Ball
28	34710.003	£ 0.9	2	Shaft Nut	81	61015.002	£ 4.3	2	Retaining Screw
29	41640.069	£ 2.2	1	Gasket	82	83102.120	£ 0.2	1	Needle Valve Gasket
30		£ 0	1	Bottom Bowl Cover	83	79503	£ 6.8	1	Needle Valve
31		£ 0	1	Carburetor Body	84		£ 0	1	Fuel Union
32		£ 0	1	Throttle return spring	85		£ 0	1	Fuel Union
33		£ 0	1	Pump spring insert	86	41530.024	£ 0.2	1	Outer Fuel Union Gasket
34	58445.001	£ 0.4	1	Pin	87	12715.008	£ 6.5	1	Fuel Union Bolt
35		£ 0	1	Pump Control Lever	88	37022.010	£ 3.2	1	Fuel Filter
36	64955.007	£ 10	1	Stud	89	41530.024	£ 0.2	1	Gasket
37	64955.101	£ 10.8	1	Stud	92	55525.010	£ 0.4	1	Washer
38	32650.001	£ 2.8	2	Throttle Shaft Bearing	93	52135.008	£ 2.2	1	Blanking plate
39	64570.006	£ 1.8	4	Throttle Plate Screw	94	ST2283	£ 0.7	1	Blanking plate gasket
40	64005.059	£ 6.8	2	Throttle Plate	99	45048.007	£ 10.5	1	Throttle lever
41	10005.438	£ 20.8	1	Throttle Shaft	100	ST2559	£ 15.8	1	Rod with ball ends
42	64700.004	£ 1.7	2	Cold Start Fixing Screw	104	ST2460	£ 3.6	1	Ball end Left thread
43	55510.038	£ 0	2	Flat Washer	105	ST1937	£ 3.6	1	Ball end Right thread
44	58445.001	£ 0.4	1	Fixing pin	106	ST1936	£ 4.3	1	Universal lever
45	92433.805	£ 0	1	Pump rod	107		£ 0		Pump rod
46	41565.002	£ 0.4	1	O ring	108		£ 0		Spring
47	32556.018	£ 32.2	1	Cold Start Unit	109		£ 0		Washer
48	41565.002	£ 0.4	2	O ring	110		£ 0		Spring
49	34720.002	£ 0	1	Nut	111		£ 0		Pump rod insert
50	45025.029	£ 0	1	Lever	112		£ 0		Washer
51	64800.002	£ 0	1	Wire screw	113		£ 0		
52	34715.010	£ 0	1	Nut	114		£ 0		
53	47610.006	£ 5.4	1	Return Spring	115	39174.020	£ 0	1	Pump assembly

<https://www.carbparts.eu>

Prices and product availability are subject to change

