

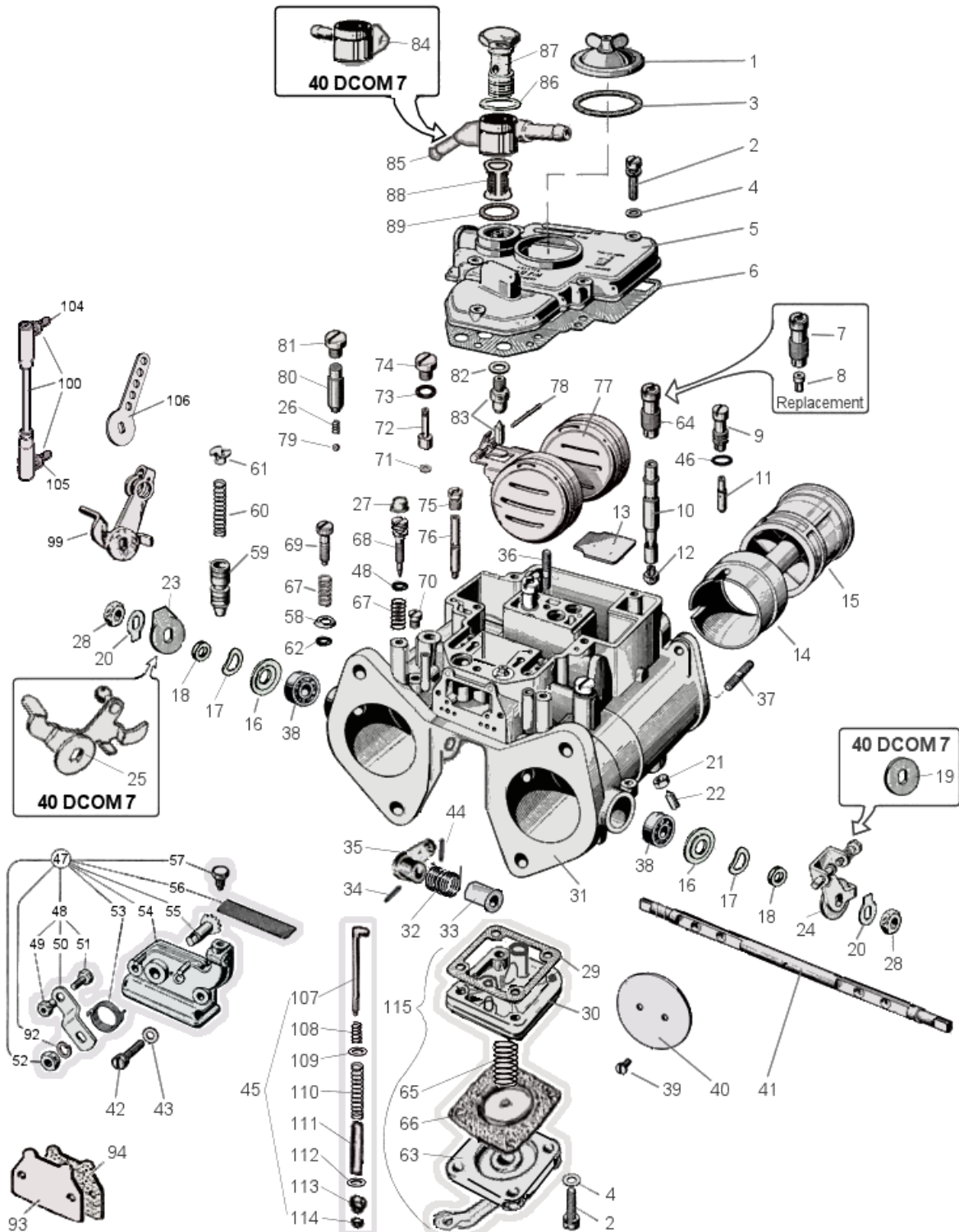

WEBER 40 DCOM 6/7 - exploded view

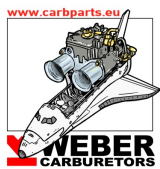



CarbDeal
Selling carburetor parts since 2005



WEBER 40 DCOM 6/7 - Parts list

No	Part No	Price	Pcs	Description	No	Part No	Price	Pcs	Description
1	32376.003	\$ 9.5	1	Jet Cover	54	32556.001	\$ 0	1	Cold Start Unit Body
2	64700.001	\$ 0.6	9	Cover Screw	55	10085.003	\$ 0	1	Shaft
3	41550.002	\$ 3	1	Gasket	56	37000.016	\$ 4.5	1	Filter Screen
4	55510.034	\$ 0.5	5	Washer	57	64605.017	\$ 2.1	1	Fixing Bolt
5		\$ 0	1	Carb Top Cover	58	58000.006	\$ 2.2	1	Cup washer
6	41715.011	\$ 2	1	Carb. Cover Gasket	59	64330.014	\$ 7	2	Starter Valve
7	52580.001	\$ 5.5	2	Emulsion Tube Holder	60	47600.243	\$ 5.3	2	Starter Valve Spring
8	77401	\$ 5.2	2	Air Corrector Jet	61	52030.003	\$ 3.5	2	Spring Retainer
9	52585.005	\$ 21.1	2	Idle Jet Holder	62	41565.002	\$ 0.5	2	O ring
10	61450.261	\$ 0	2	Emulsion Tube	63		\$ 0	1	Pump bottom
11	74800	\$ 3.5	2	Idle Jet	64	77511.160	\$ 0	2	Emulsion tube holder with air corrector
12	73401	\$ 15	2	Main Jet	65	47600.250	\$ 6	1	Pump Spring
13	52130.003	\$ 2	1	Plate	66	47407.267	\$ 14	1	Pump Diaphragm
14	72303.320	\$ 0	2	Choke Tube	67	47600.007	\$ 2.6	2	Idle Screw Spring
15	69909.600	\$ 68.7	2	Auxiliary Venturi	68	64750.058	\$ 6	2	Idle Mixture Screw
16	41570.001	\$ 1.2	2	Dust Cover	69	64625.012	\$ 6.5	1	Throttle stop screw
17	47600.063	\$ 2.2	2	Spring	70	61015.002	\$ 6	2	Progression Hole Plug
18	58000.007	\$ 3.2	2	Retaining Cover	71	41535.021	\$ 1.3	2	Pump Gasket
19	55555.010	\$ 2	1	Washer	72	76818.035	\$ 5.8	2	Pump Jet
20	55520.004	\$ 1.2	2	Lock washer	73	41565.009	\$ 0.7	2	Pump Cover Seal
21	34710.003	\$ 1.2	1	Lock Nut	74	61015.008	\$ 9	2	Pump Cover
22	64830.006	\$ 4.4	1	Locking screw	75	77505.150	\$ 7	1	Starter air jet
23		\$ 0	1	Stop washer	76	75507.085	\$ 12	2	Starter Jet
24	45048.149	\$ 18	1	Balance lever	77	41030.005	\$ 39.5	1	Float
25		\$ 0	1	Throttle lever	78	52000.001	\$ 1.9	1	Float Fulcrum Pin
26	47600.296	\$ 0	1	Spring	79	58300.003	\$ 2.5	2	Pump Valve Ball
27	61075.021	\$ 0	1	Mixture screw cap	80	52730.004	\$ 11	2	Stuffing Ball
28	34710.003	\$ 1.2	2	Shaft Nut	81	61015.002	\$ 6	2	Retaining Screw
29	41640.069	\$ 3	1	Gasket	82	83102.120	\$ 0.3	1	Needle Valve Gasket
30		\$ 0	1	Bottom Bowl Cover	83	79503	\$ 9.5	1	Needle Valve
31		\$ 0	1	Carburetor Body	84		\$ 0	1	Fuel Union
32		\$ 0	1	Throttle return spring	85		\$ 0	1	Fuel Union
33		\$ 0	1	Pump spring insert	86	41530.024	\$ 0.3	1	Outer Fuel Union Gasket
34	58445.001	\$ 0.5	1	Pin	87	12715.008	\$ 9	1	Fuel Union Bolt
35		\$ 0	1	Pump Control Lever	88	37022.010	\$ 4.4	1	Fuel Filter
36	64955.007	\$ 13.9	1	Stud	89	41530.024	\$ 0.3	1	Gasket
37	64955.101	\$ 15	1	Stud	92	55525.010	\$ 0.5	1	Washer
38	32650.001	\$ 3.9	2	Throttle Shaft Bearing	93	52135.008	\$ 3	1	Blanking plate
39	64570.006	\$ 2.5	4	Throttle Plate Screw	94	ST2283	\$ 1	1	Blanking plate gasket
40	64005.059	\$ 9.5	2	Throttle Plate	99	45048.007	\$ 14.3	1	Throttle lever
41	10005.438	\$ 29	1	Throttle Shaft	100	ST2559	\$ 22	1	Rod with ball ends
42	64700.004	\$ 2.4	2	Cold Start Fixing Screw	104	ST2460	\$ 5	1	Ball end Left thread
43	55510.038	\$ 0	2	Flat Washer	105	ST1937	\$ 5	1	Ball end Right thread
44	58445.001	\$ 0.5	1	Fixing pin	106	ST1936	\$ 6	1	Universal lever
45	92433.805	\$ 0	1	Pump rod	107		\$ 0		Pump rod
46	41565.002	\$ 0.5	1	O ring	108		\$ 0		Spring
47	32556.018	\$ 45	1	Cold Start Unit	109		\$ 0		Washer
48	41565.002	\$ 0.5	2	O ring	110		\$ 0		Spring
49	34720.002	\$ 0	1	Nut	111		\$ 0		Pump rod insert
50	45025.029	\$ 0	1	Lever	112		\$ 0		Washer
51	64800.002	\$ 0	1	Wire screw	113		\$ 0		
52	34715.010	\$ 0	1	Nut	114		\$ 0		
53	47610.006	\$ 7.5	1	Return Spring	115	39174.020	\$ 0	1	Pump assembly

<https://www.carbparts.eu>

Prices and product availability are subject to change

